

**BPI® BarGrip XL COUPLER**

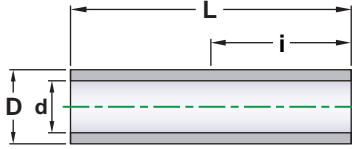

REBAR SIZE mm [CAN]	BarGrip XL PRODUCT CODE	BarGrip XL COLOR CODE*	COUPLER WEIGHT (kg)	COUPLER DIMENSIONS (mm)				FIELD INSTALLATION DIMENSIONS (mm) (SEE BELOW)					
				LENGTH 'L'	OUTSIDE DIA. 'D'	INSIDE DIA. 'd'	BAR INSERTION 'i'	PRESS MODEL	'H'	'S'	'T'	'X'	'U'
10	03XL	ORANGE	0.11	83	19	13	41	BG 250	83	41	51	117	57
12	04XL	PINK	0.18	102	24	16	51		95	44	54	127	60
16 [15M]	05XL	RED	0.31	121	29	19	60		108	48	57	171	64
20 [20M]	06XL	YELLOW	0.57	140	35	24	70	BG 400	143	76	108	194	133
22	07XL	BLUE	0.80	159	40	27	79		159	76	114	222	140
25 [25M]	08XL	BLACK	1.17	178	44	30	89		171	83	114	241	140
28	09XL	RED	1.50	191	49	35	95	BG 750	191	83	133	292	159
[30M]	30M-XL	RED	1.41	191	49	36	95		191	83	133	292	159
32	10XL	YELLOW	2.05	210	56	38	105		203	89	140	318	165
36 [35M]	11XL	BLUE	2.60	229	60	43	114	BG 1140	219	89	146	333	165
38	12XL	BROWN	3.70	248	68	46	124		244	117	174	349	225
40	13XL	BLACK	4.75	260	70	47	130		255	118	176	366	226
43 [45M]	14XL	PINK	5.40	279	75	50	140	BG 1140	264	121	178	385	229
50	16XL	GRAY	7.50	320	86	59	160		300	127	191	475	235
57 [55M]	18XL	RED	10.9	356	97	67	178		330	133	203	528	241

ALL DIMENSIONS ARE APPROXIMATE

**BPI® BarGrip XL TRANSITION SERIES**

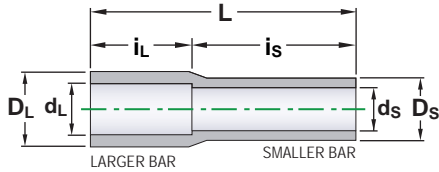

REBAR SIZE (mm/mm)	TRANSITION PRODUCT CODE	COLOR CODE*		COUPLER WEIGHT (kg)	COUPLER DIMENSIONS (mm)						FIELD PRESS MODEL	
		LG	SM		LENGTH 'L'	LARGE OUTSIDE 'DL'	SMALL OUTSIDE 'DS'	LARGE INSIDE 'dl'	SMALL INSIDE 'ds'	BAR INSERTION LARGE 'iL'		SMALL 'is'
16/12	05/04XL	RED	PINK	0.17	88	27	22	19	16	35	55	BG 250
20/12	06/04XL	YEL.	PINK	0.27	104	35	22	24	16	33	70	BG 400
20/16	06/05XL		RED	0.33	104	35	27	24	19	40	64	
22/16	07/05XL	BLUE	RED	0.45	121	40	27	27	19	43	78	
22/20	07/06XL		YEL.	0.55	121	40	35	27	24	52	68	
25/20	08/06XL	BLK	YEL.	0.78	137	44	35	30	24	64	73	
25/22	08/07XL		BLUE	0.80	137	44	40	30	27	64	73	
28/22	09/07XL	RED	BLUE	0.86	156	49	40	33	27	73	83	BG 750
28/25	09/08XL		BLK	1.14	156	49	44	33	30	73	83	
32/25	10/08XL	YEL.	BLK	1.59	175	56	44	38	30	75	100	
32/28	10/09XL		RED	1.60	175	56	49	38	33	78	97	
36/25	11/08XL	BLUE	BLK	1.72	185	60	44	41	30	67	117	BG 1140
36/28	11/09XL		RED	1.79	185	60	49	41	33	80	105	
36/32	11/10XL	YEL.	1.99	185	60	56	41	38	83	102		
38/32	12/10XL	BRO.	YEL.	2.37	197	67	56	46	38	83	114	
40/32	13/10XL	BLK	YEL.	2.77	210	70	56	46	38	92	117	
43/32	14/10XL	PINK	YEL.	3.13	226	73	56	49	38	92	134	BG 1140
43/36	14/11XL		BLUE	3.20	226	73	60	49	41	92	134	
57/36	18/11XL	RED	BLUE	6.62	294	97	60	67	41	111	183	
57/43	18/14XL		PINK	7.57	294	97	73	67	49	111	183	

ALL DIMENSIONS ARE APPROXIMATE

**BarGrip STRUCTURAL CONNECTOR**

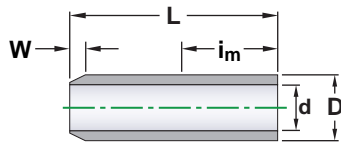

REBAR SIZE mm [CAN]	BarGrip XL PRODUCT CODE	BarGrip XL COLOR CODE*	COUPLER WEIGHT (kg)	DIMENSIONS (mm)				
				LENGTH 'L'	OUTSIDE DIA. 'D'	INSIDE DIA. 'd'	MINIMUM INSERTION 'im'***	WELDING BEVEL 'W'
10	03LB	ORANGE	0.12	83	19	13	25	5
12	04LB	PINK	0.18	102	24	16	32	5
16 [15M]	05LB	RED	0.30	121	29	19	41	6
20 [20M]	06LB	YELLOW	0.55	140	35	24	48	6
22	07LB	BLUE	0.77	159	40	27	57	8
25 [25M]	08LB	BLACK	1.13	178	44	30	64	10
28	09LB	RED	1.45	191	49	35	70	11
32	10LB	YELLOW	2.00	210	56	38	79	13
36 [35M]	11LB	BLUE	2.50	229	60	43	89	14
38	12LB	BROWN	3.55	248	68	46	97	15
40	13LB	BLACK	4.60	260	70	47	102	16
43 [45M]	14LB	PINK	5.26	279	75	50	114	17
50	16LB	GRAY	7.30	320	86	59	133	19
57 [55M]	18LB	RED	10.7	356	97	67	156	22

\*\*\* Minimum Insertion equals the swage length. Maximum Rebar Insertion can be up to the full coupler length.

ALL DIMENSIONS ARE APPROXIMATE

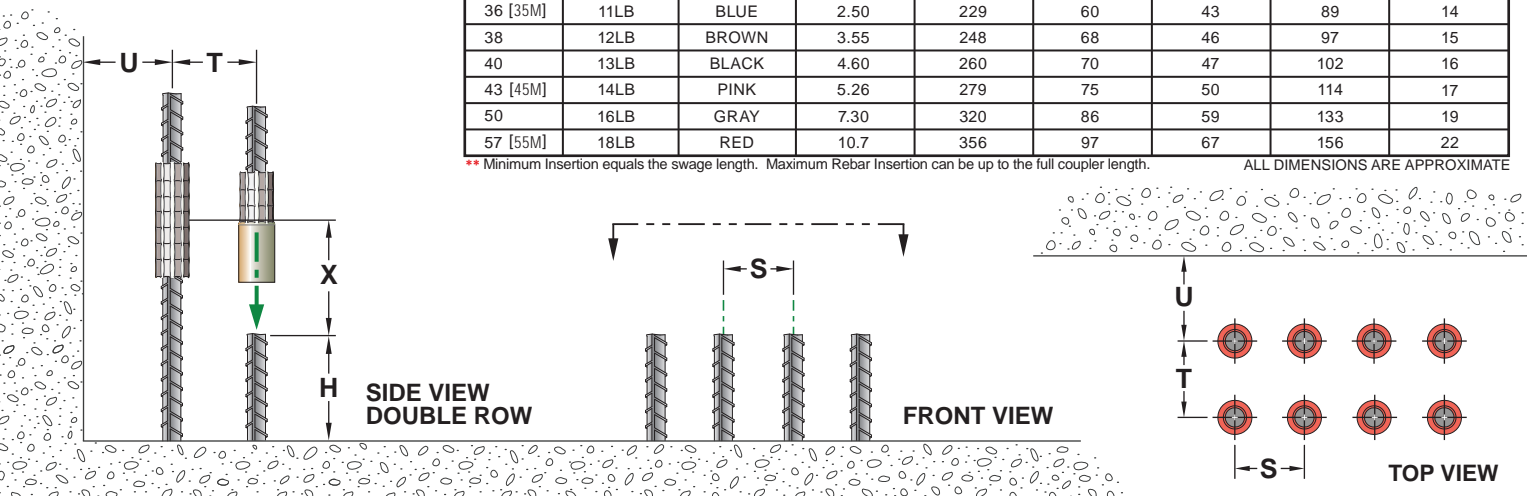

**BPI® BarGrip SWAGING EQUIPMENT**

[ See BarGrip Splicing Manual ( SM02 ) for more details ]

*BPI® Equipment is available for lease or purchase.*

*Equipment must be used in accordance with manuals, lease agreements, manufacturers' directions and all safety instructions.*

**BG750M**

MIDSIZE FIELD PRESS

weighs 41 kg [90 lbs]

(mostly used on Ø 25, 29, 32 & 36 mm bar)



**BG1140M**

HEAVY-DUTY FIELD PRESS

weighs 91 kg [200 lbs]

(mostly used on Ø 32, 36, 43 & 57 mm bar)



**BG400**

COMPACT FIELD PRESS

weighs 28 kg [60 lbs]

(mostly used on Ø 20, 22 & 25 mm bar)



**BG250**

MINI FIELD PRESS

weighs 9 kg [20 lbs]

(mostly used on Ø 12 & 16 mm bar)

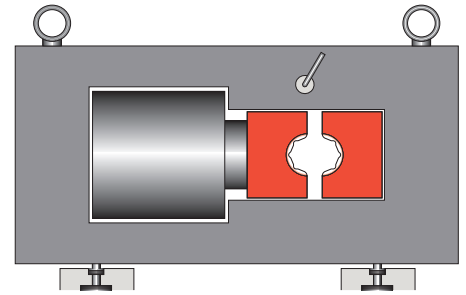
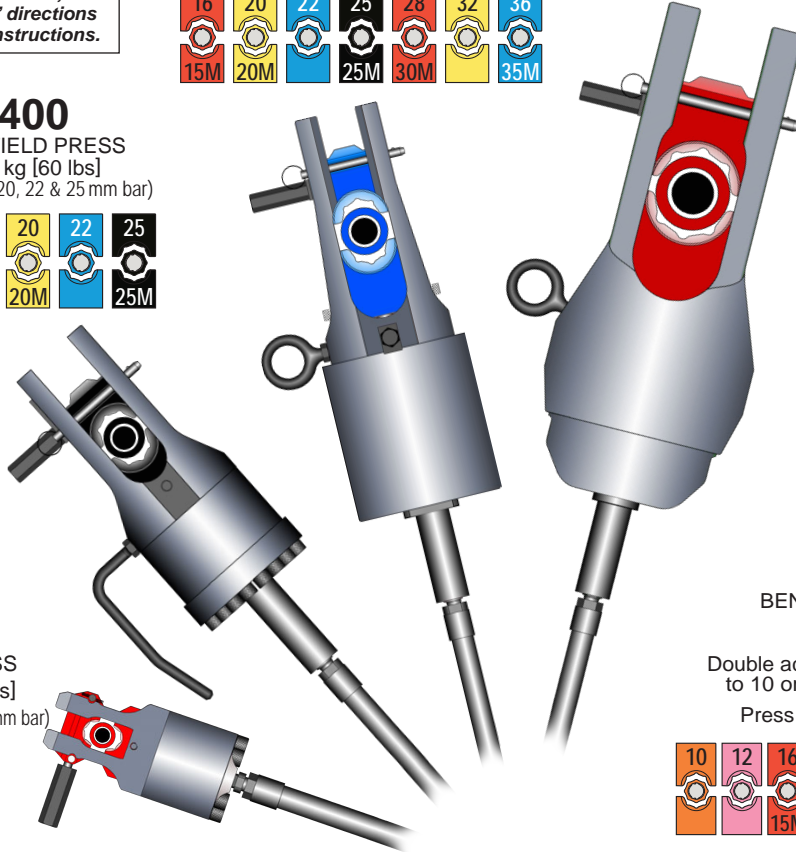

**BP2600**

BENCH PRESS for swaging all sizes up to Ø 57 mm

weighs 725 kg [1,600 lbs]

Double acting cylinder produces 272 tonnes of force connected to 10 or 15 hp pump for high fabrication shop productivity.

Press includes foot control, lifting eyes and leveling feet.



**BPI® swaging equipment** for the installation of **BarGrip** cold swaged coupling sleeves and structural connectors consists of a hydraulic **PRESS, PUMP** and **HOSE** with suitable swaging **DIES**.

Press models for field swaging range in size from the BG 250 for splicing Ø10 – 16 mm reinforcement bars (15M), to the BG 1140M for splicing bars up to Ø57 mm (55M). Each press is provided with a lifting handle and/or lifting eye for support. With a simple change of the die set, each press is capable of swaging multiple sizes of coupling sleeve inclusive of BarGrip XL, XL Transitions and Structural Connectors. For ease of use, dies and coupling sleeves are stamped and color-coded to match.

A hydraulic pump (electrically-driven or gasoline-driven) connects to the press by means of a hose with quick-disconnect ends. The equipment operator depresses a foot control to actuate the system. As the ram of the press extends and pushes the dies towards each other, a portion of the coupling sleeve is forced to deform around the rebar and interlock with the bar profile. When each swaging bite has been completed, a pressure switch, built into the pump, automatically stops the process to allow the ram of the press to retract for the next bite. After a coupling sleeve has been fully swaged, the operator simply removes the outer die pin and slides the outer die out of the press for convenient removal of the press from around the spliced rebar.

Pump Model	PE 55	PE 400	PG 400
Driver	1 ½ HP Electric Motor	10 HP Electric Motor	18 HP Gasoline Engine
Power Supply	115V 1-phase	230V or 460V 3-phase	Battery Start
Weight with fluid	66 kg (147 lbs)	274 kg (605 lbs)	247 kg (545 lbs)
Most common use	Rebar Ø10 - 36 mm	Ø28 - 57 mm	Ø28 - 57 mm
Attributes	Compact / Maneuverable	Fast / High volume jobs	No power supply required

**A BPI BP 2600 Bench Press can be utilized by the rebar fabricator to efficiently half-swage coupling sleeves to reinforcement bar ahead of shipping, thereby saving time and labor on the jobsite.**

*NOTE: In lieu of shop half-swaging with a Bench Press, it may sometimes be appropriate to use a field press such as a BG 750M or BG 1140M – Contact BPI for assistance with your specific application.*

\* COLOR CODE OF COUPLER MUST MATCH COLOR OF DIE SET

While the information contained in this document is believed to be accurate at the time of publication, BPI reserves the right to make changes, design modifications, corrections and other revisions as it sees fit, without notice. All products described herein are supplied in accordance with BPI's standard Terms and Conditions of Sale. This document is of a promotional nature only. Aspects of structural design, evaluation of product fitness for use, suitability or similar attributes are the responsibility of others.



**DOWNLOAD THE FREE BARSPICE APP AND FOLLOW US ON SOCIAL MEDIA!**



Barsplice Products, Inc., 4900 Webster Street, Dayton OH 45414, USA  
Tel: 937-275-8700 • www.barsplice.com • e-mail: bar@barsplice.com



Copyright © 2023, Barsplice Products, Inc., "BPI". All rights reserved.