

CONTROL | FLEXIBILITY | SAVE ON SHIPPING | GREAT FOR PRECAST PARKING GARAGES!

The **BPI® Precast NC Panel Connector** is a unique rebar coupler that provides control and flexibility in connecting precast panels. With this system, users can quickly install female components using BarSplice Products' BP2600 hydraulic press and in-house rebar. The threaded male bars produced by BPI are then installed onsite, eliminating safety risks associated with protruding rebar.

System Components:

- Customer supplied sheared rebar
- NC Bolt Connector (with or without flange)
- BPI Barsplicer XP Thread

Equipment Needed:

- BP 2600 Swaging Press

Advantages:

- Type 2 Strength (100% f_u), Grade 60 and Grade 80 rebar
- Female component easily installed and cast in-house
- BPI male threaded bars sizes #4 - #11, installed onsite
- Enhances safety and simplifies shipping
- High-quality rebar threads produced by BarSplice Products (No rebar threading equipment required)

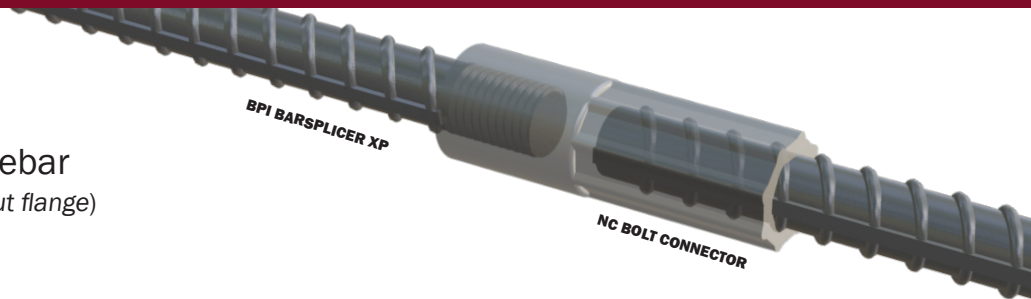

STEP ONE:

Simply swage the NC Bolt Connector onto your own in-house rebar.

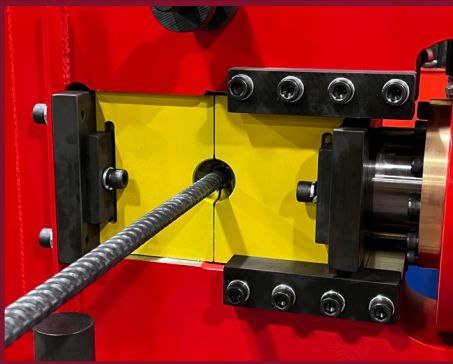

STEP TWO:

Bolt the coupler in place prior to concrete pour.



STEP THREE:

Thread BPI BarSplicer XP bar into the coupler at the jobsite.

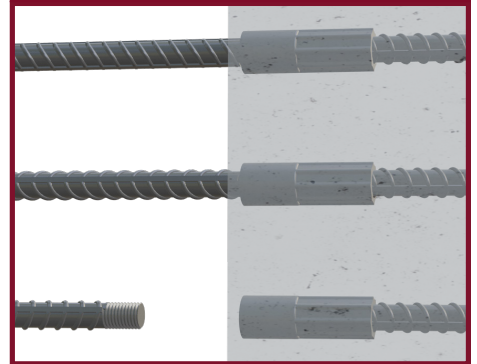

Contact your
Regional Sales Manager
for more information:
(937) 275-8700



4900 Webster Street
Dayton, Ohio 45414
www.barsplice.com

BPI® Precast NC Panel Connector

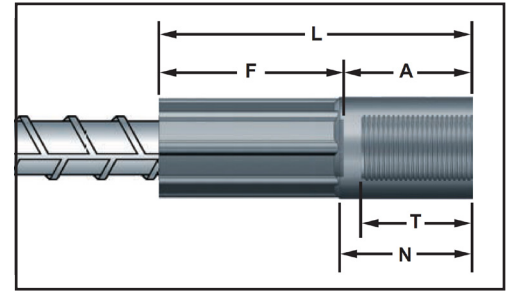

REBAR SIZE US [Metric]	UNC THREAD SIZE	WEIGHT (lbs)	SWAGING DIE SET COLOR CODE	CONNECTOR OUTSIDE DIA.	BAR INSERTION AFTER SWAGING	FINAL LENGTH AFTER SWAGING	THREAD LENGTH	END ALLOWANCE	NON-SWAGED LENGTH
					F	L	T	A	N
#4 [13]	½ - 13	.30	PINK	⅞	1 ¾	2 15/16	⅞	1 3/16	1 5/16
#5 [16]	5/8 - 11	.58	RED	1 ⅛	2 ¼	3 9/16	15/16	1 3/8	1 9/16
#6 [19]	¾ - 10	1.09	YELLOW	1 3/8	2 ¾	4 ¼	1 ⅞	1 9/16	1 13/16
#7 [22]	⅞ - 9	1.62	BLUE	1 9/16	3 ⅛	4 15/16	1 ½	1 7/8	2 ⅛
#8 [25]	1 - 8	2.31	BLACK	1 ¾	3 9/16	5 5/8	1 ½	2 ⅛	2 3/8
#9 [29]	1 ⅛ - 7	3.17	RED	1 15/16	4	6 3/8	2	2 7/16	2 ¾
#10 [32]	1 ¼ - 7	4.45	YELLOW	2 3/16	4 ½	7 3/16	2 ¼	2 ¾	3 ⅛
#11 [36]	1 ⅜ - 6	5.39	BLUE	2 3/8	4 7/8	7 5/8	2 3/8	2 ¾	3 ⅛

Download the free BarSplice Products App







Industry Affiliations:



While the information contained in this document is believed to be accurate at the time of publication, BPI reserves the right to make changes, design modifications, corrections and other revisions as it sees fit, without notice. All products described herein are supplied in accordance with BPI's standard Terms and Conditions of Sale. This document is of a promotional nature only. Aspects of structural design, evaluation of product fitness for use, suitability, or similar attributes are the responsibility of others.



4900 Webster Street, Dayton, Ohio 45414 USA
(937) 275-8700 | barsplice.com | bar@barsplice.com

